

YASKAWA



Real size, infinite possibilities

NEW



Small Robot

MotoMINI

Dimensions Units: mm  : P-point Maximum Envelope

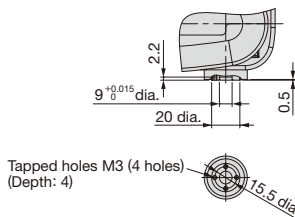
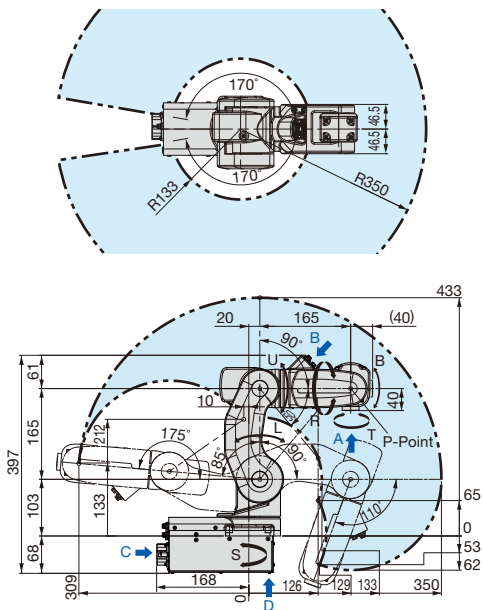

View A

Connector for internal user I/O wiring harness: DE-9SF-N
Matching connector: DE-9PF-N (provided by users)
2×Air inlet (M5 tapped hole, with pipe plug)

Connector for internal user I/O wiring harness: DE-9SF-N
Matching connector: DE-9PF-N (provided by users)
2×Air inlet (M5 tapped hole, with pipe plug)

View C

View B

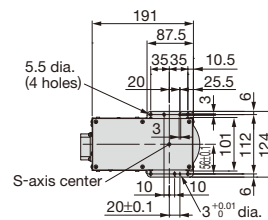

View D

Specifications	MotoMINI	
Type	YR-1-06VX05-A00	
Controlled Axis	6 (vertically articulated)	
Payload*1	0.5 kg	
Repeatability*2	±0.02 mm	
Range of Motion	S-axis (turning)	-170° - +170°
	L-axis (lower arm)	-85° - +90°
	U-axis (upper arm)	-50° - +90°
	R-axis (wrist roll)	-140° - +140°
	B-axis (wrist pitch/yaw)	-30° - +210°
	T-axis (wrist twist)	-360° - +360°
Maximum Speed	S-axis (turning)	5.5 rad/s, 315°/s
	L-axis (lower arm)	5.5 rad/s, 315°/s
	U-axis (upper arm)	7.3 rad/s, 420°/s
	R-axis (wrist roll)	10.5 rad/s, 600°/s
	B-axis (wrist pitch/yaw)	10.5 rad/s, 600°/s
	T-axis (wrist twist)	10.5 rad/s, 600°/s
Allowable Moment	R-axis (wrist roll)	0.42 N·m (0.043 kgf·m)
	B-axis (wrist pitch/yaw)	0.42 N·m (0.043 kgf·m)
	T-axis (wrist twist)	0.37 N·m (0.038 kgf·m)

Specifications	MotoMINI	
Allowable Inertia (GD ² /4)	R-axis (wrist roll)	0.00378 kg·m ²
	B-axis (wrist pitch/yaw)	0.00378 kg·m ²
	T-axis (wrist twist)	0.00299 kg·m ²
Approx. Mass	7 kg	
IEC Protection Class	IP20	
Ambient Conditions	Temperature	0°C to +40°C
	Humidity	20% to 80%RH (non-condensing)
	Vibration	4.9 m/s ² or less
Others	<ul style="list-style-type: none"> Free from corrosive gas or liquid, or explosive gas or liquid Free from exposure to water, oil, or dust Free from excessive electrical noise (plasma) Free from strong magnetic fields 	
	Power Requirements*3	0.5 kVA
	Mounting*4	Floor, wall, ceiling, tilt

*1: U arm payload capacity will vary according to payload carried by wrist.
*2: Conforms to ISO 9283.
*3: Varies in accordance with applications and motion patterns.
*4: There are motion limitations on S-axis for wall, tilt mounting type.
Note: SI units are used for the specifications.

Sales Department

HEAD OFFICE

2-1 Kurosaki-Shiroishi, Yahatanishi-ku, Kitakyushu, Fukuoka 806-0004, Japan
Phone: +81-93-645-7703 Fax: +81-93-645-7802

YASKAWA America, Inc. (Motoman Robotics Division)

100 Automation Way, Miamisburg, OH 45342, U.S.A.
Phone: +1-937-847-6200 Fax: +1-937-847-6277

YASKAWA Europe GmbH (Robotics Division)

Yaskawastrasse 1, 85391, Allershausen, Germany
Phone: +49-8166-90-100 Fax: +49-8166-90-103

YASKAWA Nordic AB

Verkstadsгатan 2, Box 504, SE-385 25 Torsås, Sweden
Phone: +46-480-417-800 Fax: +46-486-414-10

YASKAWA Electric (China) Co., Ltd.

22F, One Corporate Avenue, No.222 Hubin Road, Huangpu District, Shanghai 200021, China
Phone: +86-21-5385-2200 Fax: +86-21-5385-3299

YASKAWA SHOUANGANG ROBOT CO., LTD.

No.7 Yongchang North Road, Beijing E&T Development Area China 100176
Phone: +86-10-6788-2858 Fax: +86-10-6788-2878

YASKAWA India Private Ltd. (Robotics Division)

#426, Udyog Vihar Phase-IV, Gurgaon, Haryana, India
Phone: +91-124-475-8500 Fax: +91-124-475-8542

YASKAWA Electric Korea Corporation

35F, Three IFC, 10 Gukjegeumyung-ro, Yeongdeungpo-gu, Seoul, Korea 07326
Phone: +82-2-784-7844 Fax: +82-2-784-8495

YASKAWA Electric Taiwan Corporation

12F, No.207, Sec. 3, Beishin Rd., Shindian District, New Taipei City 23143, Taiwan
Phone: +886-2-8913-1333 Fax: +886-2-8913-1513

YASKAWA Electric (Singapore) PTE Ltd

151 Lorong Chuan, #04-02A New Tech Park, Singapore 556741
Phone: +65-6282-3003 Fax: +65-6289-3003

YASKAWA Electric (Thailand) Co., Ltd.

59, 1st-5th Floor, Flourish Building, Soi Ratchadapisek 18, Ratchadapisek Road, Huaykwang, Bangkok 10310, Thailand
Phone: +66-2-017-0099 Fax: +66-2-017-0199

PT. YASKAWA Electric Indonesia

Secure Building-Gedung B Lantai Dasar & Lantai 1 Jl. Raya Protokol Halim Perdanakusuma, Jakarta 13610, Indonesia
Phone: +62-21-2982-6470 Fax: +62-21-2982-6471

YASKAWA

YASKAWA ELECTRIC CORPORATION

In the event that the end user of this product is to be the military and said product is to be employed in any weapons systems or the manufacture thereof, the export will fall under the relevant regulations as stipulated in the Foreign Exchange and Foreign Trade Regulations. Therefore, be sure to follow all procedures and submit all relevant documentation according to any and all rules, regulations and laws that may apply. Specifications are subject to change without notice for ongoing product modifications and improvements.

© 2017 YASKAWA ELECTRIC CORPORATION

LITERATURE NO. CHEP C941111 03A

Published in Japan June 2017